

4CBT(Y) - CBT(Y)

2.0 to 6.0 ton
Electric Towing Tractor

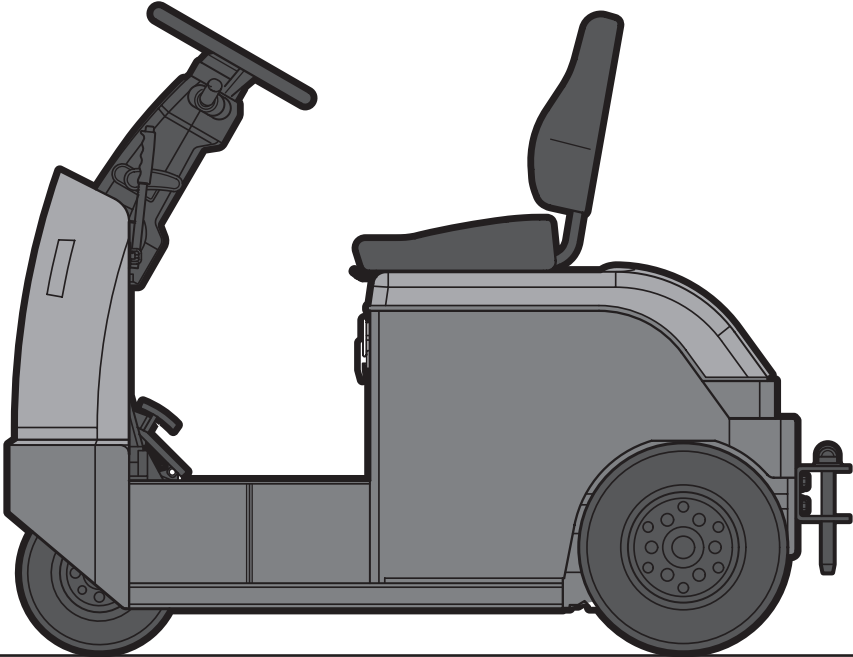

2,000 - 4,000 kg compact, stand-on

MAIN VEHICLE SPECIFICATIONS

| | | | | TOYOTA | | |
|-----------------|----------------|--|--------------------------|----------------|---------------------|---------------------|
| | | | | 4CBTY2 | 4CBTYk4 | |
| Characteristics | 1.1 | Manufacturer | | | TOYOTA | TOYOTA |
| | 1.2 | Model | | | 4CBTY2 | 4CBTYk4 |
| | 1.3 | Power unit | | | battery | battery |
| | 1.4 | Operator Type | | | stand-on | stand-on |
| | 1.5 | Load capacity/rated load | Q | kg | 2000 | 4000 |
| | 1.7 | Rated drawbar pull | F | N | 500 | 1000 |
| 1.9 | Wheelbase | y | mm | 1140 | 1140 | |
| Weight | 2.1 | Truck weight | | kg | 620 | 730 |
| | 2.2 | Axle loadings laden front/rear | | kg | - | - |
| | 2.3 | Axle loadings unladen front/rear | | kg | 220/400 | 270/460 |
| Tyres, chassis | 3.1 | Tyres - pneumatic (P), pneumatic shaped cushion (SE), solid rubber (R) | | | P | P |
| | 3.2 | Tyre size - front | | | 3.50-5-6PR | 3.50-5-6PR |
| | 3.3 | Tyre size - rear | | | 4.00-8-6PR | 4.00-8-6PR |
| | 3.5 | Wheels - number front/rear (x = drive wheel) | | | 1/2x | 1/2x |
| | 3.6 | Track width - front | b ₁₀ | mm | - | - |
| | 3.7 | Track width - rear | b ₁₁ | mm | 670 | 670 |
| | Dimensions | 4.8 | Seat height/stand height | h ₇ | mm | 200 |
| 4.12 | | Coupling height | h ₁₀ | mm | 305 | 305 |
| 4.17 | | Overhang | l ₅ | mm | 215 | 215 |
| 4.19 | | Overall length (incl. hitch of 105 mm) | l ₁ | mm | 1645 | 1645 |
| 4.21 | | Chassis width | b ₁ | mm | 800 | 800 |
| 4.32 | | Ground clearance, centre of wheelbase | m ₂ | mm | 80 | 80 |
| 4.35 | Turning radius | W _a | mm | 1600 | 1600 | |
| Performance | 5.1 | Travel speed laden/unladen | | km/h | 9 ¹⁾ /13 | 8 ²⁾ /13 |
| | 5.6 | Max drawbar pull | | N | 2000 | 4000 |
| | 5.8 | Max. gradeability laden/unladen ³⁾ | | % | 5/14 | 7/14 |
| | 5.10 | Service brake | | | hydraulic | hydraulic |
| Motor | 6.1 | Drive motor | | kW | 2.3 | 2.3 |
| | 6.4 | Battery voltage/nominal capacity | | V/Ah | 48/129 | 48/220 |
| | 6.5 | Battery weight | | kg | 260 | 370 |
| Others | 8.1 | Control type | | | Transistor inverter | Transistor inverter |
| | 8.4 | Sound level at driver's ear | | dB(A) | | |

¹⁾ with 2 ton load

²⁾ with 4 ton load

³⁾ Computed values, 3-minute rating

TOWED WEIGHT

| Model | Start on grade | | | |
|--|-----------------|---------|------------------|---------|
| | 3-minute Rating | | 60-minute rating | |
| | 4CBTY2 | 4CBTYk4 | 4CBTY2 | 4CBTYk4 |
| Surface condition (Dry even concrete) | ton | ton | ton | ton |
| Level road | 2.0 | 4.0 | 2.0 | 4.0 |
| Grade (degrees) | 1° | 1.6 | 3.7 | 2.0 |
| | 2° | 1.2 | 3.0 | 1.2 |
| | 3° | 1.0 | 2.5 | 0.7 |
| | 4° | 0.8 | 2.1 | 0.4 |

DIMENSIONAL DRAWINGS

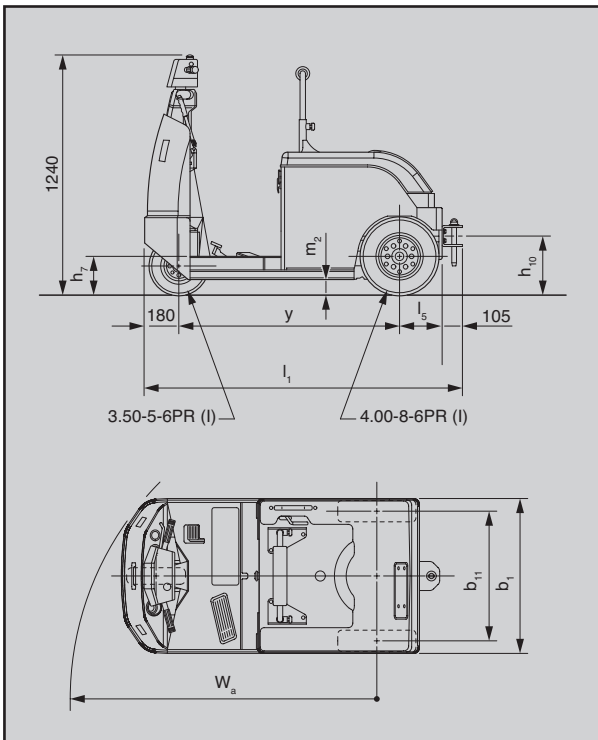

BATTERY COMPARTMENT

BATTERY CASE DIMENSIONS

| Model | Battery voltage V | Standard | Battery capacity Ah/5hr | Manufacturer | Battery cell | | | Container height (w/case) mm | Weight (w/case) kg |
|-----------------|----------------------|----------|----------------------------|--------------|--------------|--------------|-------------|------------------------------------|--------------------------|
| | | | | | Type | Length mm | Width mm | | |
| 4CBTY2, 4CBTYk4 | 48 | BRITISH | 120 | CHLORIDE | IMF7H | 61.5 | 158 | 542 | 240 |
| | | | 162 | CHLORIDE | TLF7N | 61.5 | 158 | 542 | 295 |
| | | | | OLDHAM | EXH3 | 61 | 159 | 542 | 305 |
| | | | 189 | CHLORIDE | TLF7H | 61.5 | 158 | 542 | 335 |
| | | | | OLDHAM | XH3 | 61 | 159 | 542 | 340 |
| | | DIN | 120 | CHLORIDE | 2PzS120H | 47 | 198.5 | 542 | 240 |
| | | | 160 | VARTA | 2PzS160 | 47 | 198 | 542 | 325 |
| | | | | CHLORIDE | 2PzS160 | 47 | 198.5 | 542 | 320 |
| | | | 180 | CHLORIDE | 2PzS180H | 47 | 198.5 | 542 | 325 |

Battery Connector Type: Connecteur 160A female 50° mm (Reels France)

BATTERY COMPARTMENT DIMENSIONS

| Model | Battery compartment | | |
|-----------------|---------------------|--------------|--------------|
| | Width mm | Length mm | Height mm |
| 4CBTY2, 4CBTYk4 | 763 | 353 | 548 |

2,000 - 4,000 kg compact, sit-on

MAIN VEHICLE SPECIFICATIONS

| | | | | TOYOTA | | | |
|-----------------|----------------|--|-----------------|--------|---------------------|---------------------|---------------------|
| | | | | 4CBT2 | 4CBT3 | 4CBTk4 | |
| Characteristics | 1.1 | Manufacturer | | | TOYOTA | TOYOTA | TOYOTA |
| | 1.2 | Model | | | 4CBT2 | 4CBT3 | 4CBTk4 |
| | 1.3 | Power unit | | | battery | battery | battery |
| | 1.4 | Operator Type | | | sit-on | sit-on | sit-on |
| | 1.5 | Load capacity/rated load | Q | kg | 2000 | 3000 | 4000 |
| | 1.7 | Rated drawbar pull | F | N | 500 | 750 | 1000 |
| 1.9 | Wheelbase | y | mm | 1140 | 1140 | 1140 | |
| Weight | 2.1 | Truck weight | | kg | 620 | 620 | 730 |
| | 2.2 | Axle loadings laden front/rear | | kg | - | - | - |
| | 2.3 | Axle loadings unladen front/rear | | kg | 220/400 | 220/400 | 270/460 |
| Tyres, chassis | 3.1 | Tyres - pneumatic (P), pneumatic shaped cushion (SE), solid rubber (R) | | | P | P | P |
| | 3.2 | Tyre size - front | | | 3.50-5-6PR | 3.50-5-6PR | 3.50-5-6PR |
| | 3.3 | Tyre size - rear | | | 4.00-8-6PR | 4.00-8-6PR | 4.00-8-6PR |
| | 3.5 | Wheels - number front/rear (x = drive wheel) | | | 1/2x | 1/2x | 1/2x |
| | 3.6 | Track width - front | b ₁₀ | mm | - | - | - |
| | 3.7 | Track width - rear | b ₁₁ | mm | 670 | 670 | 670 |
| Dimensions | 4.8 | Seat height/stand height | h ₇ | mm | 860 | 860 | 860 |
| | 4.12 | Coupling height | h ₁₀ | mm | 305 | 305 | 305 |
| | 4.17 | Overhang | l ₅ | mm | 215 | 215 | 215 |
| | 4.19 | Overall length (incl. hitch of 105 mm) | l ₁ | mm | 1645 | 1645 | 1645 |
| | 4.21 | Chassis width | b ₁ | mm | 800 | 800 | 800 |
| | 4.32 | Ground clearance, centre of wheelbase | m ₂ | mm | 80 | 80 | 80 |
| 4.35 | Turning radius | W _a | mm | 1600 | 1600 | 1600 | |
| Performance | 5.1 | Travel speed laden/unladen | | km/h | 9 ¹⁾ /13 | 9 ²⁾ /13 | 8 ³⁾ /13 |
| | 5.6 | Max drawbar pull | | N | 2000 | 3000 | 4000 |
| | 5.8 | Max. gradeability laden/unladen ⁴⁾ | | % | 5/14 | 7/14 | 8/14 |
| | 5.10 | Service brake | | | hydraulic | hydraulic | hydraulic |
| Motor | 6.1 | Drive motor | | kW | 2.3 | 2.3 | 2.3 |
| | 6.4 | Battery voltage/nominal capacity | | V/Ah | 48/129 | 48/129 | 48/220 |
| | 6.5 | Battery weight | | kg | 260 | 260 | 370 |
| Others | 8.1 | Control type | | | Transistor inverter | Transistor inverter | Transistor inverter |
| | 8.4 | Sound level at driver's ear | | dB(A) | | | |

¹⁾ with 2 ton load

²⁾ with 3 ton load

³⁾ with 4 ton load

⁴⁾ Computed values, 3-minute rating

TOWED WEIGHT

| Model | Surface condition (Dry even concrete) | Start on grade | | | | | |
|--------------------|--|-----------------|-------|--------|------------------|-------|--------|
| | | 3-minute Rating | | | 60-minute rating | | |
| | | 4CBT2 | 4CBT3 | 4CBTk4 | 4CBT2 | 4CBT3 | 4CBTk4 |
| Level road | | 2.0 | 3.0 | 4.0 | 2.0 | 3.0 | 4.0 |
| Grade (degrees) | 1° | 1.6 | 2.7 | 3.7 | 0.9 | 1.4 | 2.0 |
| | 2° | 1.2 | 2.1 | 3.0 | 0.4 | 0.8 | 1.2 |
| | 3° | 1.0 | 1.7 | 2.5 | 0.1 | 0.4 | 0.7 |
| | 4° | 0.8 | 1.4 | 2.1 | — | 0.2 | 0.4 |

4CBT2, 4CBT3, 4CBTk4

DIMENSIONAL DRAWINGS

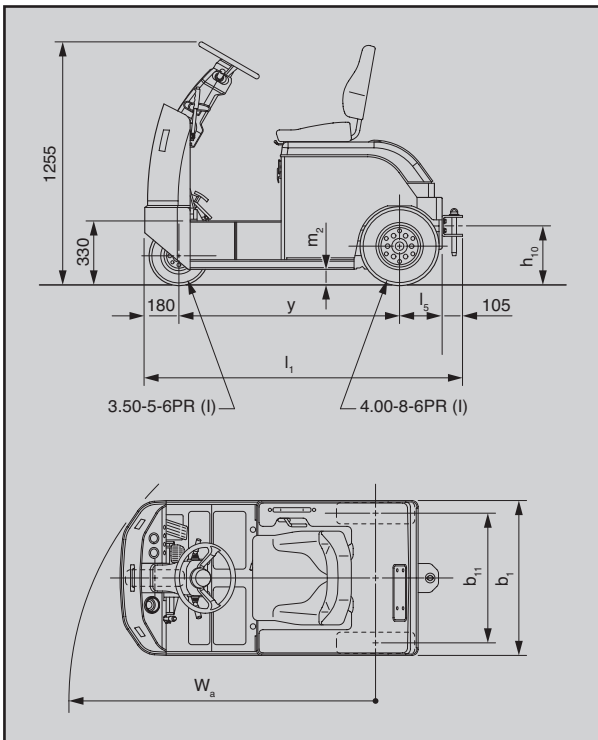

BATTERY COMPARTMENT

BATTERY CASE DIMENSIONS

| Model | Battery voltage V | Standard | Battery capacity Ah/5hr | Manufacturer | Battery cell | | | Container height (w/case) mm | Weight (w/case) kg |
|------------------------|----------------------|----------|----------------------------|--------------|--------------|--------------|-------------|------------------------------------|--------------------------|
| | | | | | Type | Length mm | Width mm | | |
| 4CBT2, 4CBT3 4CBTk4 | 48 | BRITISH | 120 | CHLORIDE | IMF7H | 61.5 | 158 | 542 | 240 |
| | | | 162 | CHLORIDE | TLF7N | 61.5 | 158 | 542 | 295 |
| | | | | OLDHAM | EXH3 | 61 | 159 | 542 | 305 |
| | | | 189 | CHLORIDE | TLF7H | 61.5 | 158 | 542 | 335 |
| | | | | OLDHAM | XH3 | 61 | 159 | 542 | 340 |
| | | DIN | 120 | CHLORIDE | 2PzS120H | 47 | 198.5 | 542 | 240 |
| | | | 160 | VARTA | 2PzS160 | 47 | 198 | 542 | 325 |
| | | | | CHLORIDE | 2PzS160 | 47 | 198.5 | 542 | 320 |
| 180 | CHLORIDE | 2PzS180H | 47 | 198.5 | 542 | 325 | | | |

Battery Connector Type: Connecteur 160A female 50° mm (Reels France)

BATTERY COMPARTMENT DIMENSIONS

| Model | Battery compartment | | |
|-------------------------|---------------------|--------------|--------------|
| | Width mm | Length mm | Height mm |
| 4CBT2, 4CBT3, 4CBTk4 | 763 | 353 | 548 |

4,000 - 6,000 kg

MAIN VEHICLE SPECIFICATIONS

| | | | | TOYOTA | | | |
|-----------------|----------------|--|-----------------|--------|-----------------------|-----------------------|----------------------|
| | | | | CBTY4 | CBT4 | CBT6 | |
| Characteristics | 1.1 | Manufacturer | | | TOYOTA | TOYOTA | TOYOTA |
| | 1.2 | Model | | | CBTY4 | CBT4 | CBT6 |
| | 1.3 | Power unit | | | battery | battery | battery |
| | 1.4 | Operator Type | | | stand-on | sit-on | sit-on |
| | 1.5 | Load capacity/rated load | Q | kg | 4000 | 4000 | 6000 |
| | 1.7 | Rated drawbar pull | F | N | 980 | 980 | 1470 |
| 1.9 | Wheelbase | y | mm | 1140 | 1360 | 1360 | |
| Weight | 2.1 | Truck weight | | kg | 915 | 970 | 1035 |
| | 2.2 | Axle loadings laden front/rear | | kg | - | - | - |
| | 2.3 | Axle loadings unladen front/rear | | kg | 290/685 | 330/650 | 360/695 |
| Tyres, chassis | 3.1 | Tyres - pneumatic (P), pneumatic shaped cushion (SE), solid rubber (R) | | | P | P | P |
| | 3.2 | Tyre size - front | | | 3.50-5-6PR | 3.50-5-6PR | 3.50-5-6PR |
| | 3.3 | Tyre size - rear | | | 4.00-8-6PR | 4.00-8-6PR | 4.00-8-6PR |
| | 3.5 | Wheels - number front/rear (x = drive wheel) | | | 2/2x | 2/2x | 2/2x |
| | 3.6 | Track width - front | b ₁₀ | mm | 260 | 260 | 260 |
| | 3.7 | Track width - rear | b ₁₁ | mm | 790 | 790 | 790 |
| Dimensions | 4.8 | Seat height/stand height | h ₇ | mm | 200 | 860 | 860 |
| | 4.12 | Coupling height | h ₁₀ | mm | 305 | 305 | 305 |
| | 4.17 | Overhang | l ₅ | mm | 240 | 360 | 360 |
| | 4.19 | Overall length (incl. hitch of 105 mm) | l ₁ | mm | 1755 | 2020 | 2020 |
| | 4.21 | Chassis width | b ₁ | mm | 965 | 965 | 965 |
| | 4.32 | Ground clearance, centre of wheelbase | m ₂ | mm | 75 | 80 | 80 |
| 4.35 | Turning radius | W _a | mm | 1600 | 1775 | 1775 | |
| Performance | 5.1 | Travel speed laden/unladen | | km/h | 9 ¹⁾ /13.5 | 9 ¹⁾ /13.5 | 13 ²⁾ /18 |
| | 5.6 | Max drawbar pull | | N | 3920 | 3920 | 4410 |
| | 5.8 | Max. gradeability laden/unladen ³⁾ | | % | 6 ¹⁾ /36 | 6 ¹⁾ /36 | 3 ²⁾ /32 |
| | 5.10 | Service brake | | | hydraulic | hydraulic | hydraulic |
| Motor | 6.1 | Drive motor | | kW | 2.6 | 2.6 | 4.9 |
| | 6.4 | Battery voltage/nominal capacity | | V/Ah | 48/160 | 48/240 | 48/240 |
| | 6.5 | Battery weight | | kg | 290 | 450 | 450 |
| Others | 8.1 | Control type | | | Transistor chopper | Transistor chopper | Transistor chopper |
| | 8.4 | Sound level at driver's ear | | dB(A) | 71 | 71 | 69 |

¹⁾ with 2 ton load

²⁾ with 3 ton load

³⁾ Computed values, 3-minute rating

TOWED WEIGHT

| Model | Surface condition (Dry even concrete) | Start on grade | | | | | |
|--------------------|--|-----------------|---------|---------|------------------|---------|---------|
| | | 3-minute Rating | | | 60-minute rating | | |
| | | CBTY4 | CBT4 | CBT6 | CBTY4 | CBT4 | CBT6 |
| | | ton | ton | ton | ton | ton | ton |
| Level road | | 4.0 (7) | 4.0 (7) | 6.0 (7) | 4.0 (7) | 4.0 (7) | 6.0 (7) |
| Grade (degrees) | 1° | 3.4 (4) | 3.4 (4) | 3.8 (4) | 1.9 (7) | 1.9 (7) | 3.0 (7) |
| | 2° | 2.7 (4) | 2.7 (4) | 3.0 (4) | 1.0 (7) | 1.0 (7) | 1.8 (7) |
| | 3° | 2.2 (4) | 2.2 (4) | 2.4 (4) | 0.5 (7) | 0.5 (7) | 1.1 (7) |
| | 4° | 1.7 (4) | 1.7 (4) | 2.0 (4) | 0.2 (7) | 0.2 (7) | 0.6 (7) |

() indicates travel speed in km/h

DIMENSIONAL DRAWINGS

CBTY4

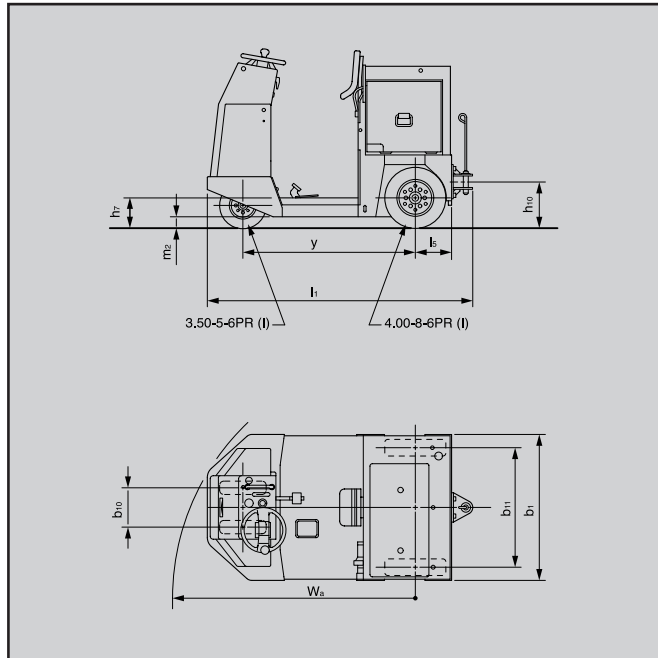

CBT4.6

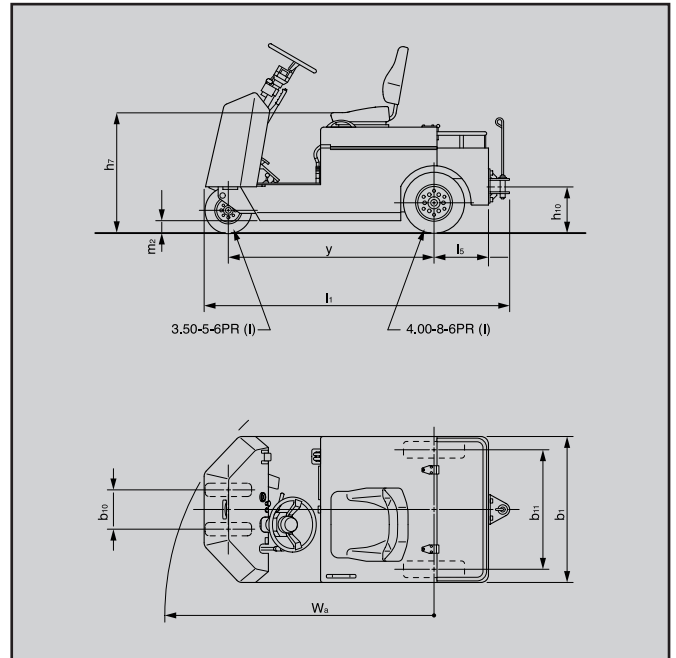

BATTERY COMPARTMENT

STD BATTERY CASE DIMENSIONS

| Model | Standard | Battery voltage/ capacity | Manufacturer | Battery cell | | | Container height | Weight with case |
|----------------------|----------|------------------------------|--------------|--------------|--------|-------|---------------------|---------------------|
| | | | | Type | Length | Width | | |
| | | V/Ah/5hr | | | | mm | mm | kg |
| CBTY4 (roll out) | British | 48/216 | OLDHAM | AE4 | 77 | 159 | 468 | 380 |
| | DIN | 48/160 | OLDHAM | DW2 | 47 | 198 | 468 | 290 |
| CBT4.6 (lift out) | British | 48/270 | OLDHAM | AE5 | 93 | 157.5 | 575 | 470 |
| | | | CHLORIDE | TLF-11N | 93.5 | 158 | 575 | 490 |
| | | | VARTA | 5PEC270 | 95 | 159 | 575 | 510 |
| | DIN | 48/240 | OLDHAM | DW3 | 64.5 | 198 | 575 | 450 |
| | | | CHLORIDE | 3PzS240 | 65 | 198.5 | 575 | 453 |
| | | | VARTA | 3Pz240 | 66 | 198 | 575 | 455 |

OPTIONAL BATTERY CASE DIMENSIONS

| Model | Standard | Battery voltage/ capacity | Manufacturer | Battery cell | | | Container height | Weight with case |
|----------------------|----------|------------------------------|--------------|--------------|--------|-------|---------------------|---------------------|
| | | | | Type | Length | Width | | |
| | | V/ Ah/5hr | | | | mm | mm | kg |
| CBT4.6 (roll out) | British | 48/210 | OLDHAM | A05 | 93 | 157.5 | 500 | 383 |
| | | | CHLORIDE | ILF11N | 93.5 | 158 | 500 | 429 |
| | | VARTA | 5PEB235 | 95 | 159 | 500 | 446 | |
| | | OLDHAM | AE5 | 95 | 157.5 | 500 | 465 | |
| | DIN | 48/210 | CHLORIDE | 3PzS210 | 65 | 198.5 | 500 | 381 |
| | | | VARTA | 3PzS210 | 65 | 198 | 500 | 369 |
| | | 48/219 | OLDHAM | DVH3 | 64.5 | 198 | 500 | 395 |

BATTERY COMPARTMENT DIMENSIONS

| Model | Battery compartment | | |
|--------|---------------------|--------|-----------|
| | Width | Length | Height |
| | | | |
| | | | |
| CBTY4 | 742 | 499 | 475 |
| CBT4.6 | 818 | 497 | 594 (523) |

() for optional roll out battery

4CBTY2, 4CBTYk4, 4CBT2, 4CBT3, 4CBTk4,

- Toyota OPS (Operator Presence Sensing)
- AC power system
- Pneumatic tyres
- Rear drawbar
- Headlight
- Battery discharge indicator
- Hour meter

CBTY4, CBT4, CBT6

- Toyota OPS (Operator Presence Sensing)
- Pneumatic tyres
- Rear drawbar
- Headlight
- Battery discharge indicator
- Hour meter
- Battery rollerbed (only standard on CBTY4)
- Document box

Specifications are based on Toyota testing standards.

Operating performance may vary depending on the actual specification and condition of the truck as well as the condition of the operating area.

Continuous improvements make it necessary for us to reserve the right to make specification and equipment changes.

Specifications are subject to manufacturing tolerances. Availability and specifications are determined regionally. Please consult your Toyota representative for more details.